

**SOMERSET
HOUSE**

CONFERENCES AT

SOMERSET HOUSE

VENUE HIRE

Built on historic foundations at the very heart of the capital, Somerset House is London's working arts centre, home to the UK's largest creative community and one of the city's best loved public spaces.

Run as a charity by Somerset House Trust, all event hire income directly contributes to the venue's cultural public programme, education and outreach work and helps maintain the Grade I listed site for over three million visitors to enjoy annually - you can be confident that your event will be directly supporting an organisation offering immense value to an audience that goes far beyond your attendees.

The grandeur and heritage of Somerset House's diverse venue, coupled with the expertise of the Commercial Events team, offer an unrivalled location for unforgettable events.

somersethouse.com/venuehire





NAVY BOARD ROOMS

Located on the first floor of the South Wing, the Navy Board Rooms are a spacious and versatile suite of rooms, offering a contemporary location for your conference.

With original features, natural light and uninterrupted views across the River Thames, the Navy Board Rooms offer a stylish and versatile backdrop for your event in one of London’s most unique venues.

View a 360 Virtual Tour of the Navy Board Rooms [here](#).

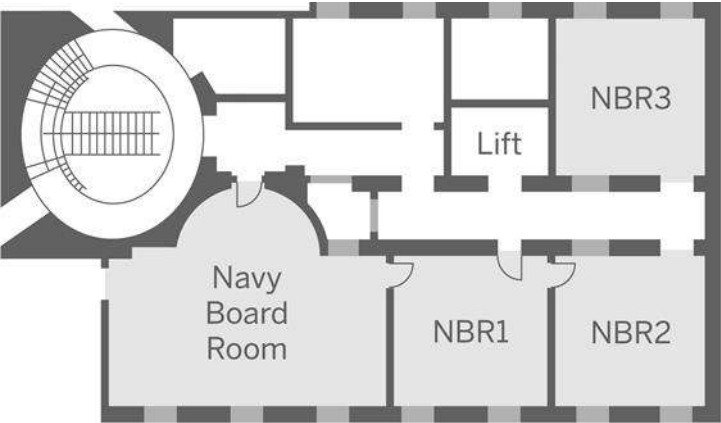

60 THEATRE STYLE

NBR	Navy Board Room	10m x 5.5m
NBR 1	Navy Board Room 1	5.5m x 5.5m
NBR 2	Navy Board Room 2	5.5m x 6m
NBR 3	Navy Board Room 3	5.5m x 5.2m



DAY DELEGATE RATES

Exclusive hire of the Navy Board Rooms for guests from 08.30 until 16.00, including two breakout spaces for catering

All packages include:

- Catering (Choose from three options;
Gourmet Sandwich Lunch, Fork Buffet, or Vegan Buffet)
- Chairs, Lectern and Stage
- 65" Screen
- Laptop
- 2 x white, wireless Speakers
- Lectern, Lapel and hand held Microphones
- Wi-Fi Access (15 Mbps)
- Cloakroom
- A dedicated Technician for the duration of the event
- A dedicated Event Manager

From **£120 + VAT** per person
based on a minimum of 50
maximum capacity 60 guests theatre style





CATERING

Restaurant Associates Event's modern British menus are adapted throughout the year in order to incorporate seasonal ingredients.

Their belief is that food should be fresh, uncomplicated and contemporary. Our menu is plants-forward and committed to ethically reared meat and MSC 1-3 rated fish.

Choose from three options;

GOURMET SANDWICH LUNCH

A choice of four options from the sandwich, baguette/ciabatta and wrap menu and two salads (April-September) or, one salad and one soup (October-March).

£120 +VAT per person

FORK BUFFET

A choice of five options from the hot, cold and salad fork buffet lunch menu.

£130 +VAT per person

VEGAN BUFFET

A choice of five options from the hot and cold vegan buffet lunch menu.

£130 +VAT per person

All packages include:

Arrival, mid-morning and mid-afternoon freshly brewed tea and coffee with snacks and fruit.

Please ask you Event Manager for menus and more information.

Based on a minimum of 50, maximum capacity 60 guests

We understand that putting on an event has to be an enjoyable experience, which is why our dedicated team are here to help you.





ADDITIONS

AUDIO VISUAL

Backdrop

Backdrop in brand colours. Portal around screen

£1,050 + VAT

Logo Projection & Uplighting

Uplighting in brand colour behind stage with monochrome projected logo

£450 + VAT

Live Streaming, Vinyl Logos, Branded Lectern

Additional audio visual requirements are available at an additional cost and an extra technician may be required. Please discuss this with your Event Planner.

ENHANCE YOUR EVENT

Somerset House hosts a wonderful selection of exhibitions throughout the year. Should you be interested in enhancing your event with a private view or curated tour, please see our current offers **here**.



OUR LOCATION

EVENTS TEAM

+44 (0)20 7845 4618

events@somerset house.org.uk

www.somerset house.org.uk

HOW TO FIND US

Somerset House

Strand, London WC2R 1LA

BY LONDON UNDERGROUND

Nearest stations

Temple (Circle & District lines; 250m, 5 min)

Covent Garden (Piccadilly line; 650m, 8min)

Charing Cross (Bakerloo & Northern lines; 700m, 10min)

Embankment (Circle & District lines; 700m, 10min)

Waterloo (Bakerloo, Waterloo & City, Jubilee & Northern lines; 800m, 11min)

BY RAIL

Nearest stations

Charing Cross (700m, 10min)

Blackfriars (1km, 13min)

Waterloo (1km, 13min)

BY RIVER

River Bus Services RB1, RB2 and RB6 all stop at Embankment Pier, roughly 600 metres from Somerset House.

